

Keyless Smart Card System

Smart Card Basic Function

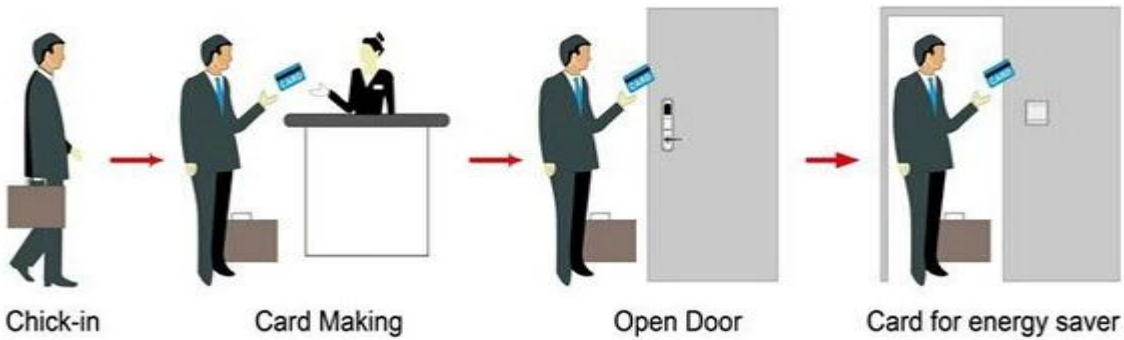

Smart Card Extensive Function



Material: TEMIC, MIFARE®
Material & Capacity: 304
Capacity: 10
Voltage: ≤ 5
Power: DC 6V, 4pcs AA
Current: $UA < 30$
Frequency: < 200 mA
Response time: 0.8
Delay: < 0.1 s
Temperature: 32-60
Customized: customerized
OS: Windows XP / 2000 / 2003/2007
Interface: hasel USB

Model: PY-8505

XXXXXXXXXXXXXXXXXXXXXXXXXXXXXXXXXXXX:



XXXXXXXXXXXXXXXXXXXXXXXXXXXXXXXXXXXX:



XXXXXXXXXXXXXXXXXXXXXXXXXXXX XXXXX XXXXX:

Accessories list reminder:



1
Door Lock
Software



2
RF Card
Reader



3
Data Collector



4
RF Card



5
Gain Power
Switch

Please confirm door opening direction as below 4 types:

right (push)	right (pull)	left (push)	left (pull)

Welcome your inquiry

