

Smart Card Basic Function

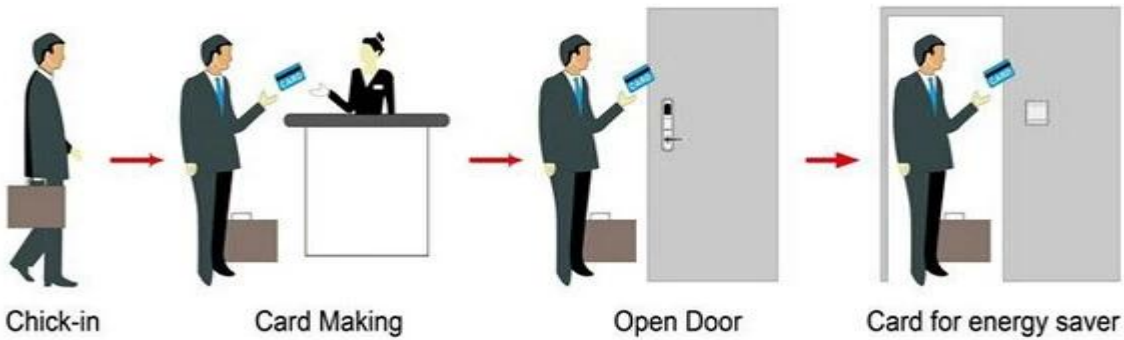

Smart Card Extensive Function



1. ID, TEMIC, MIFARE®
 2. Material: 304 stainless steel / 10 mm thick
 3. Dimensions: ≤ 5 mm
 4. Power: 6V, AA alkaline (4 pcs)
 5. Current: < 30 uA
 6. Voltage: < 200 mA
 7. Weight: 0.8 g
 8. Response time: < 0.1 s
 9. Frequency: 32-60 kHz
 10. Customized: customerized
 11. Applications: library, hospital, school, office, factory, parking, access control, etc.
 12. Price: 1 dollar per card
 13. OEM / ODM
 14. Software: Windows XP / 2000 / 2003/2007
 15. Interface: hassel USB

PY-8391 smart card

HOTEL LOCK SYSTEM
ONE-CARD-PASS



1. [RF Card](#) (RF Card) --- 1pcs/lot
2. [RF Card](#) (RF Card) (1pcs/lot)---
3. [RF Card](#) (RF Card) --- 1pcs/lot
4. [RF Card](#) (RF Card) (3 pcs =) --- 1pcs/lot
5. [RF Card](#) (1pcs/lot, [RF Card](#)) --- 1pcs/lot
6. [RF Card](#) (RF Card) --- 1pcs/lot

[RF Card](#) (RF Card) --- 1pcs/lot



□□□□ □□ □□ □□□□□□ □□□□□□□□:



□□□□ □□□□ □□ □□ □□□□ □□□□□□:



□□□□ □□□□□□ □□ □□□□□□□□ □□ □□□□□:



Accessories list reminder:



1
Door Lock
Software



2
RF Card
Reader



3
Data Collector



4
RF Card



5
Gain Power
Switch

Please confirm door opening direction as below 4 types:

right (push)	right (pull)	left (push)	left (pull)

Welcome your inquiry