

Branding Hotel Lock suppliers china PY-8011-6

supplier: [Finger & ID card access control company](#), [rfid access control system](#), [access control system price](#)

Smart Card Basic Function

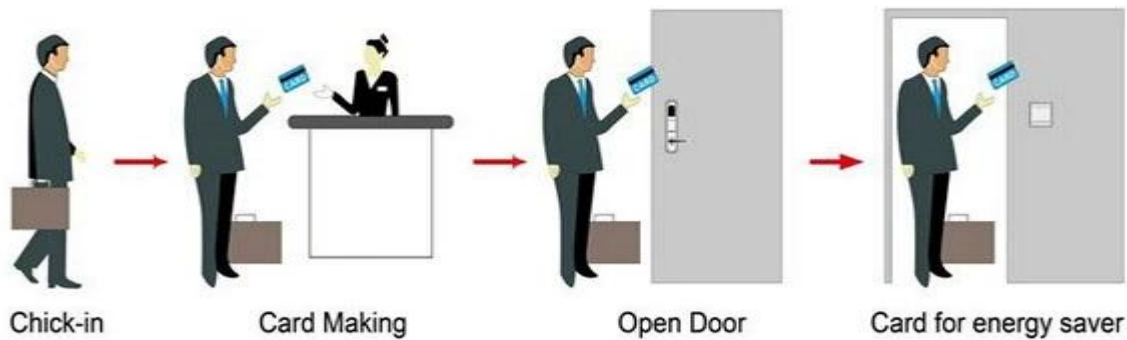

Smart Card Extensive Function



Card Type ID, TEMIC, MIFARE®

Lock Matrial Front&back&handle 304 stainless steel

Card Life 10 years

Inductive distance $\leq 5\text{cm}$

Power Supply DC 6V , 4pcs of AA alkaline batteries

Static Power consumption $< 30\text{ uA}$

Dynamic power consumption $< 200\text{ mA}$

Single operation 0.8 seconds

Card read time $< 0.1\text{s}$

Install door thickness 32-60 mm

Facial color Can be customerized

package includes complete lock,software and demo video

Language support Chinese, English, Portuguese,Turkish,Russian

Warranty: 1 year warranty

Service OEM or ODM

Compatible network Windows XP / 2000 / 2003/2007

Technology advanced hassel USB technology

Model PY-8181

HOTEL LOCK SYSTEM

ONE-CARD-PASS



1. [Hotel Lock suppliers china](#) Lock (qty = guest room)---For open the door
2. Encoder (1pcs/hotel) ---For issuing all kinds of cards
3. Switch (qty = guest room)---To get the power
4. Cards (qty = 3 times of guest room)----For open the lock
5. Data collector (1pcs/hotel, optional)----For getting the time and times of the entrance information from the lock
6. Self developed software (free of charge)----For setting the program the whole system.

Our careful and fabulous workers:



Our happy and contented customers:



Our fast and prompt delivery:



Our confidence and success in exhibition:



Accessories list reminder:



1
Door Lock
Software



2
RF Card
Reader



3
Data Collector



4
RF Card



5
Gain Power
Switch

Please confirm door opening direction as below 4 types:

right (push)	right (pull)	left (push)	left (pull)

Welcome your inquiry 