

A SYSTEM PY-8320 including:

A: MIFARE® card hotel lock, (use with USB port card encoder and software)

B: Temic card hotel lock, (use with USB port card encoder and software)

C: EM hotel lock, (use standalone, no need software)

Smart Card Basic Function

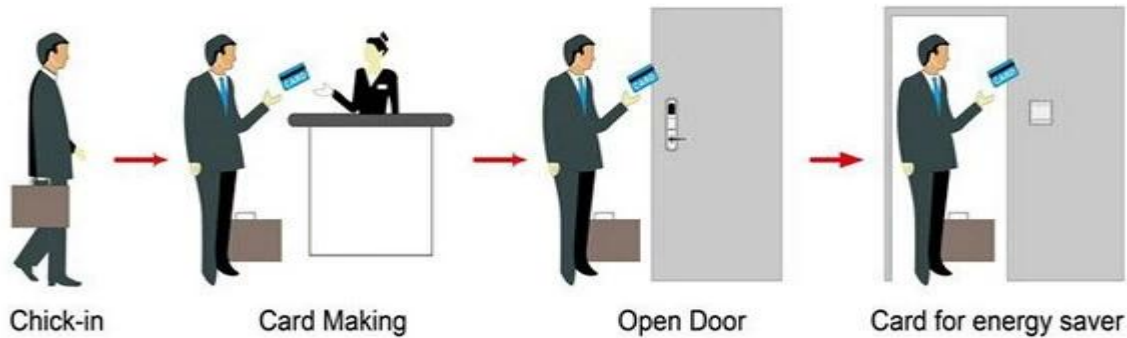

Smart Card Extensive Function



Single operation 0.8 seconds

Card read time < 0.1s

Install door thickness 32-60 mm

Facial color Can be customerized

package includes complete lock, software and demo video

Language support Chinese, English, Portuguese, Turkish, Russian

Warranty: 1 year warranty [Electronic Magnetic lock manufacturer, wholesale hotel door lock system, electric lock suppliers china](#)

Service OEM or ODM

Compatible network Windows XP / 2000 / 2003/2007

Technology advanced hassel USB technology

HOTEL LOCK SYSTEM

ONE-CARD-PASS



1. electronic door lock for hotel Lock (qty = guest room)---For open the door
2. Encoder (1pcs/hotel) ---For issuing all kinds of cards
3. Switch (qty = guest room)---To get the power
4. Cards (qty = 3 times of guest room)----For open the lock
5. Data collector (1pcs/hotel, optional)----For getting the time and times of the entrance information from the lock
6. Self developed software (free of charge)----For setting the program the whole system.

Our careful and fabulous workers:



Our happy and contented customers:



Our fast and prompt delivery:



Our confidence and success in exhibition:



Accessories list reminder:



1
Door Lock
Software



2
RF Card
Reader



3
Data Collector



4
RF Card



5
Gain Power
Switch

Please confirm door opening direction as below 4 types:

right (push)	right (pull)	left (push)	left (pull)

Extended function:

Access control

For common area, or main doors etc. same software, same card

Elevator control

For elevator. same software, same card

Room status

For guest room, come with door bell

Welcome your inquiry

