

**Stylish guest room electronic door lock system for hotel PY-8017 including:**

A: MIFARE® card hotel lock, ( use with USB port card encoder and software)

B: Temic card hotel lock, ( use with USB port card encoder and software)

C: EM hotel lock, (use standalone, no need software)

## Smart Card Basic Function

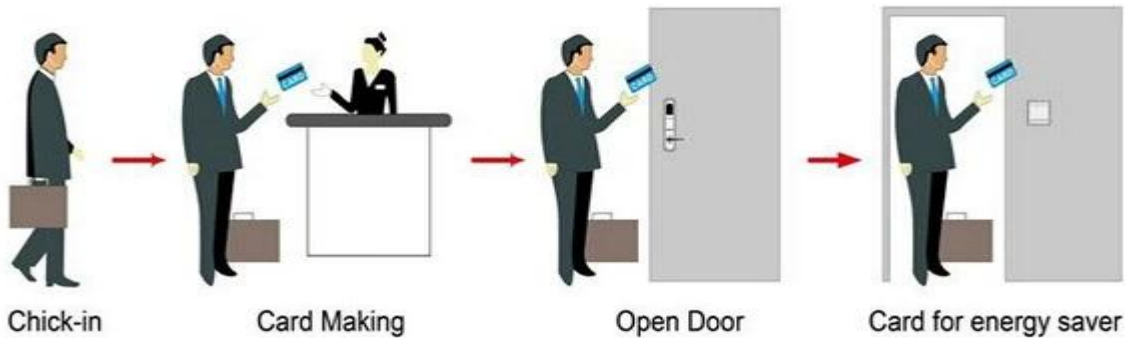

## Smart Card Extensive Function



Single operation 0.8 seconds

Card read time < 0.1s

Install door thickness 32-60 mm

Facial color Can be customerized

package includes complete lock, software and demo video

Language support Chinese, English, Portuguese, Turkish, Russian

Warranty: 1 year warranty [electronic door lock system for hotel](#)

Service OEM or ODM

Compatible network Windows XP / 2000 / 2003/2007

Technology advanced hassel USB technology



PRODUCT DISPLAY

>>

## HOTEL LOCK SYSTEM ONE-CARD-PASS



1. [electronic door lock system for hotels](#) Lock (qty = guest room)---For open the door
2. Encoder (1pcs/hotel ) ---For issuing all kinds of cards

- 3.Switch (qty = guest room)---To get the power
- 4.Cards (qty = 3 times of guest room)-----For open the lock
- 5.Data collector (1pcs/hotel, optional )-----For getting the time and times of the entrance information from the lock
- 6.Self developed software ( free of charge)----For setting the program the whole system.

**Our careful and fabulous workers:**



**Our happy and contented customers:**





**Our fast and prompt delivery:**



**Our confidence and success in exhibition:**



### Accessories list reminder:



### Please confirm door opening direction as below 4 types:

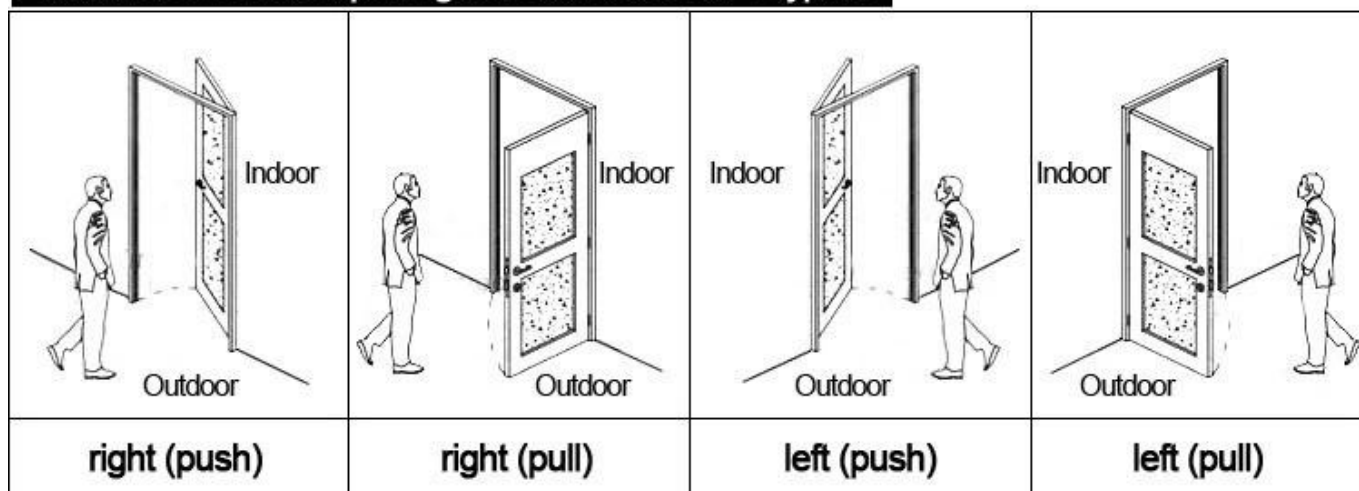

### Extended function:

#### Access control

For common area, or main doors etc. same software, same card

#### Elevator control

For elevator. same software, same card

Room status

For guest room, come with door bell

Welcome your inquiry

