

## Smart Card Basic Function

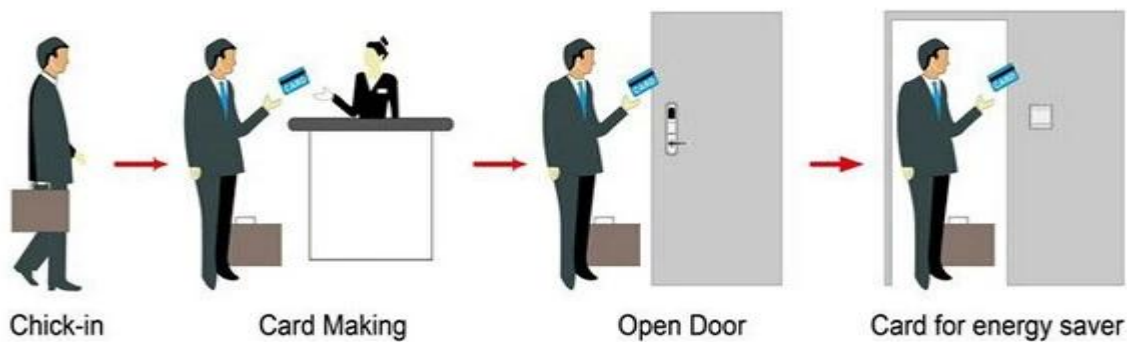

## Smart Card Extensive Function



[rfid access control system](#), [best price Temic card company](#), [access control system price](#)

## 304 Stainless steel electronic door lock system for hotels PY-8181

Card Type ID, TEMIC, MIFARE®

Lock Material Front&back&handle 304 stainless steel

Card Life 10 years

Inductive distance ≤ 5cm

Power Supply DC 6V , 4pcs of AA alkaline batteries

Static Power consumption < 30 uA

Dynamic power consumption < 200 mA

Single operation 0.8 seconds

Card read time < 0.1s

Install door thickness 32-60 mm

Facial color Can be customerized

package includes complete lock, software and demo video

Language support Chinese, English, Portuguese, Turkish, Russian

Warranty: 1 year warranty

Service OEM or ODM

Compatible network Windows XP / 2000 / 2003/2007

Technology advanced hassel USB technology

Model PY-8181

## HOTEL LOCK SYSTEM

### ONE-CARD-PASS



1. [electronic door lock system](#) Lock (qty = guest room)---For open the door
2. Encoder (1pcs/hotel ) ---For issuing all kinds of cards
3. Switch (qty = guest room)---To get the power
4. Cards (qty = 3 times of guest room)----For open the lock
5. Data collector (1pcs/hotel, optional )----For getting the time and times of the entrance information from the lock
6. Self developed software ( free of charge)----For setting the program the whole system.

**Our careful and fabulous workers:**



**Our happy and contented customers:**



**Our fast and prompt delivery:**



**Our confidence and success in exhibition:**



## Accessories list reminder:



**1**  
Door Lock  
Software



**2**  
RF Card  
Reader



**3**  
Data Collector



**4**  
RF Card



**5**  
Gain Power  
Switch

## Please confirm door opening direction as below 4 types:

<b>right (push)</b>	<b>right (pull)</b>	<b>left (push)</b>	<b>left (pull)</b>

Welcome your inquiry

